



Established over 40 years ago, Blagdon are committed to producing a comprehensive range of high quality, easy to use, pond equipment. An ongoing programme of research and development ensures excellent performance and value for all their customers. This product excellence is demonstrated by Blagdon's award winning range of water gardening equipment. As a result Blagdon's reputation for quality is unrivalled amongst experienced pond gardeners and retailers alike.

Blagdon - The Pond Masters
The name you can rely on

Interpet
Dorking, Surrey, RH4 3YX

Leaflet Code: POS 0003



THE POND MASTERS
GUIDE TO
MINIPOND
700/900 Mk2

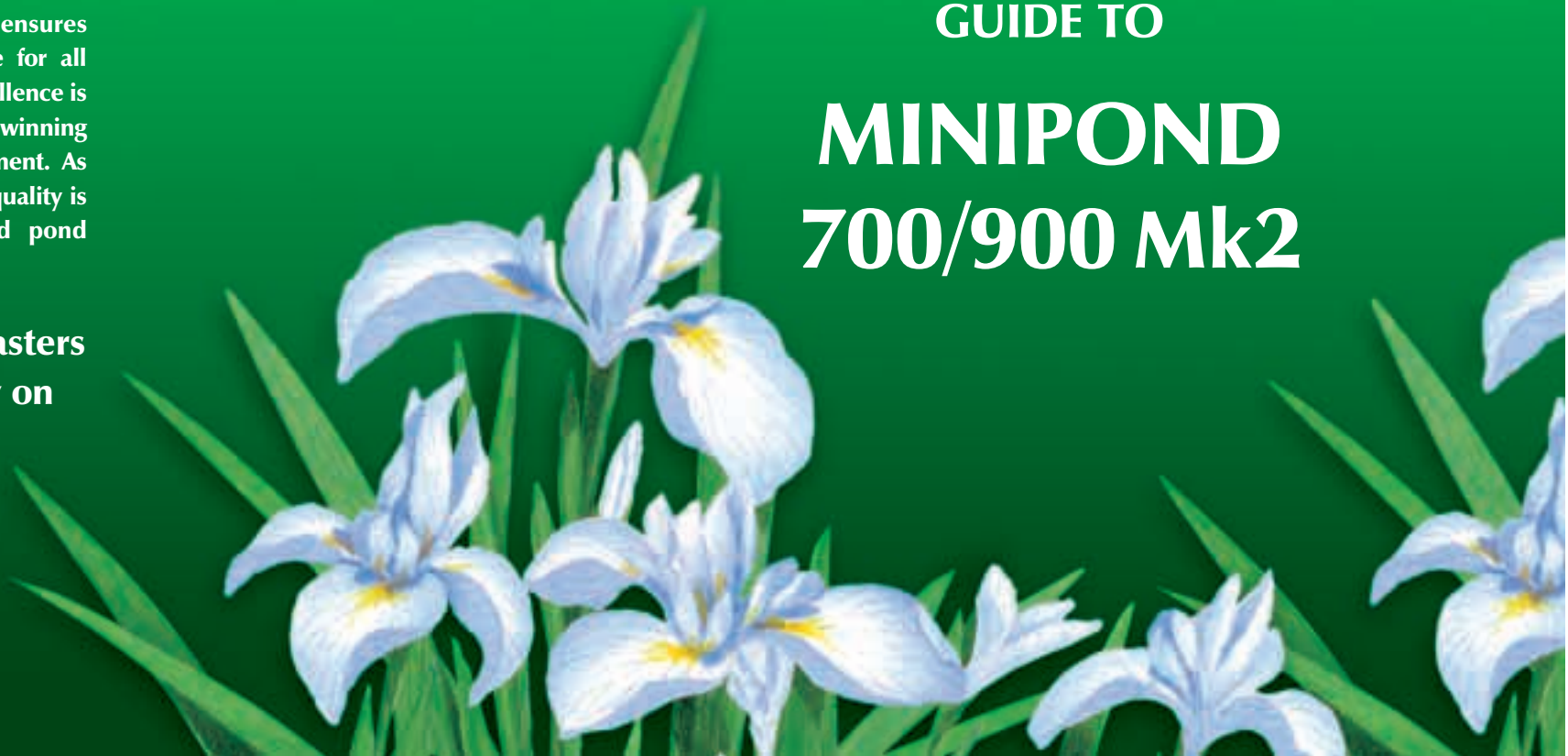



**THE POND MASTERS
GUIDE TO
MINIPOND 700/900 Mk2**

Congratulations on buying a Blagdon Minipond Fountain and Water Feature Pump. Minipond pumps are high quality pumps manufactured with advanced technology, to run pond fountains and water features. The powerful motors are easy to maintain having a single moving part impeller system featuring highly wear-resistant ceramic shaft design.

IMPORTANT

Please attach proof of purchase to this manual and file in a safe place.

CONTENTS

Getting to know your Minipond pump	3
Parts descriptions / spares codes - with exploded diagram	3-4
Technical specifications	5
Pump performance / flow chart	5
Installation	6
Electrical installation	6
Installing pump in pond	7
Maintenance and cleaning	8
Cleaning	8
Step by step guides	8-10
Routine maintenance	8-9
Monthly maintenance	9-10
Annual maintenance	10
Winter storage	10
Troubleshooting	11
Troubleshooting and maximise performance	11
Faults - problem procedure	12
Consumer advice contact details	12
Returning faulty pumps	12
Guarantee	13

GETTING TO KNOW YOUR MINIPOND PUMP

MINIPOND 700

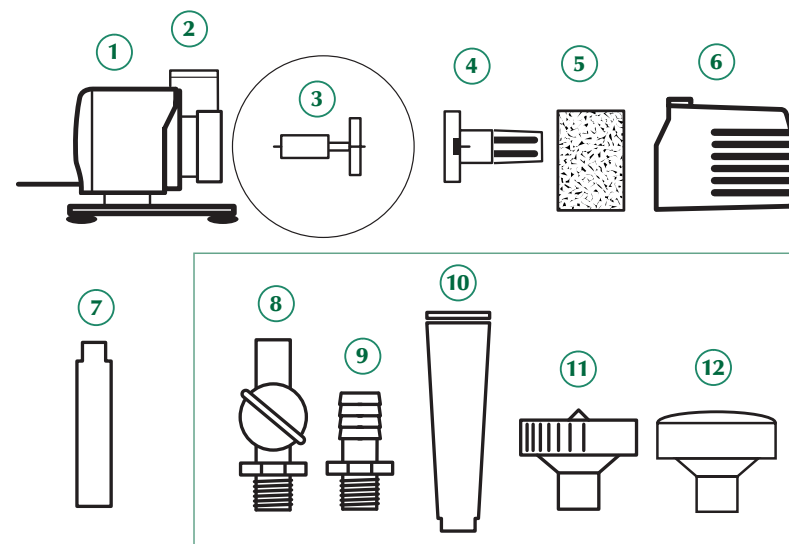

No.	Minipond 700 Part Description	Spare Code
1.	Pump motor unit	N/A
2.	Pump outlet	N/A
3.	Impeller complete	1017800
4.	Impeller cover	1017688
5.	Pre-filter foam	1017862
6.	Pre-filter cage	1017688
7.	Fountain extension pipe	1017749
8.	Fountain feature flow control	1017756
9.	1/2 inch threaded hose adaptor	1017756
10.	Water bell	1017756
11.	Daisy super	1017756
12.	Daisy	1017756

Parts 8 to 12 are supplied as one package.

GETTING TO KNOW YOUR MINIPOND PUMP

MINIPOND 900 Mk2

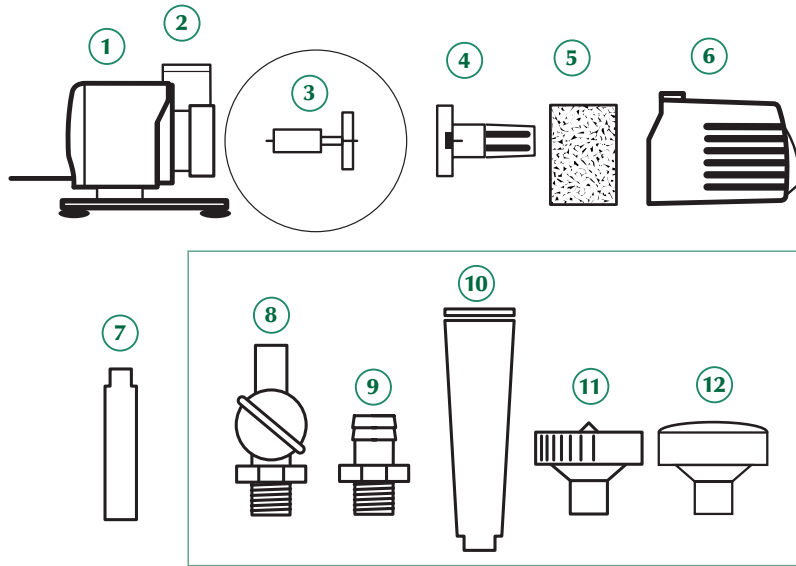

No.	Minipond 900 Mk2 Part Description	Spare Code
1.	Pump motor unit	N/A
2.	Pump outlet	N/A
3.	Impeller complete Mk2	1017817
4.	Impeller cover Mk2	1017695
5.	Pre-filter foam Mk2	1017879
6.	Pre-filter cage Mk2	1017695
7.	Fountain extension pipe	1017749
8.	Fountain feature flow control	1017763
9.	3/4 inch threaded hose adaptor	1017763
10.	Water bell large	1017763
11.	Daisy super	1017763
12.	Daisy	1017763

Parts 8 to 12 are supplied as one package.

GETTING TO KNOW YOUR MINIPOND PUMP

Pump performance / flow chart

MINIPOND	700	900 Mk2
Lift	Flow rates lph	Flow rates lph
2.0 metres	-	100 lph
1.5 metres	-	400 lph
1.0 metres	300 lph	550 lph
0.5 metres	520 lph	800 lph
0.0 metres	700 lph	872 lph
Flow is given as optimum rate		

Technical Specification and Performance

MINIPOND	700	900 Mk2
Cable Fitted	10 metres	10 metres
Voltage	230V	230V
Hertz	50Hz	50Hz
Watts	10	18
Safety Rating	IP68 CE	IP68 CE
Maximum Depth	1.25 metres	2 metres
Maximum Lift	1.25 metres / 4'1"	2 metres / 6'6"

INSTALLATION

Electrical installation



The power supply must meet the specifications on the product.

The pump is intended to be used with either a weather-proof cable connector or permanently connected to the fixed wiring in the main system other than by means of a plug and socket.

The cores in the supply cable are coloured in accordance with the following code: **Brown = Live, Blue = Neutral, Green/Yellow = Earth.**

The electric cable is permanently connected and sealed in the motor body. If the supply cable is damaged the pump must not be used.

Do not use the supply cable to lift the pump as this may cause damage.



WARNING - THIS PUMP MUST BE EARTHED

A Residual Current Device (RCD), also known as the Residual Current Circuit Breaker (RCCB), with a tripping current not exceeding 30mA must be installed in the supply circuit.

A means of disconnection from the supply having a contact separation of at least 3mm in all poles must be incorporated in the fixed wiring.

For permanent installations to the mains supply, it is necessary to conform to the regulations of the local electricity authority and this would include the use of a metal or plastic conduit to protect the cable.

Attention has been drawn to the fact that special rules may exist concerning the installation of your pond pump (i.e. local building regulations).

These pumps must not be used in swimming pools, or areas where people are in contact with the water.

Always disconnect the mains electricity supply whilst the equipment is being installed, repaired, maintained or handled. Consult a qualified electrician if in any doubt about wiring this product to the main supply.



Warning - The Minipond pump is provided with a thermal cut out that temporarily switches off the pump in case of overheating and the pump may automatically restart.

INSTALLATION

Locating your Minipond

The Minipond pump should be located on a firm and level base in the pond/water feature in a depth of at least 10cm, but no more than 1m (700 Mk2) 2m (900 Mk2).

It is advisable to keep the pump off the bottom of the pond to avoid silt entering the pump causing excessive wear and increasing pre-filter cleaning.

Fountain

Make sure there is ample cable from mains supply. Place pump in desired location. Add Fountain extension pipes so fountain head is above surface of the pond. Fountain height can now be adjusted, see 'Adjusting flow control' diagram below. See "Getting to know your Minipond" for parts and descriptions.

ADJUSTING FLOW CONTROL

Turn clockwise to increase anti-clockwise to reduce flow.

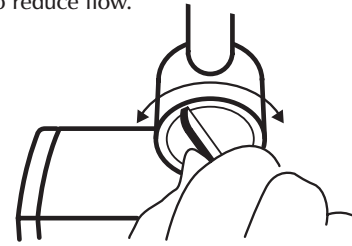

BELL FOUNTAIN

Adjust bell by moving head higher for small bell and lower for a wider bell shape.

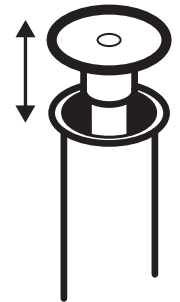

Tip: Ensure that any fountain or feature fitted does not empty water out of pond/water feature.

Water Feature

Install as for Fountain. Depending on water feature to be supplied, your Minipond can be used with the flow control and the 1/2" hose fitting or 3/4" hose fitting (not supplied with 700 model) which can be screwed directly into pump body. Hose clips should be used to secure hose.

Tip: The larger 3/4" hose will give maximum performance when fitted to the Minipond 900 Mk2.

MAINTENANCE & CLEANING



Warning - Failure to carry out routine maintenance leaving the pump under reduced or no flow conditions for long periods (i.e. blocked pre-filter) will result in a shorter pump life and will invalidate the guarantee.

Blagdon Minipond 700 and 900 Mk2 are centrifugal pumps with a magnetic impeller movement driven by a watertight synchronous motor. They require minimum cleaning, only periodic cleaning of the pre-filter and impeller is necessary.

Cleaner

The use of Blagdon Pond Pump Cleaner will give improved performance and pump life by removing built up lime scale and waste. Use before dismantling for easier and cleaner handling.

Routine Maintenance

Carry out routine maintenance when pump flow is visibly reduced.

1. Switch off electricity.
2. Remove pump from pond (do not use the cable to lift the pump).
3. Follow steps 1 and 2.

STEP 1: MINIPOND 700 (ROUTINE)

Firmly pull pre-filter cage from pump motor.

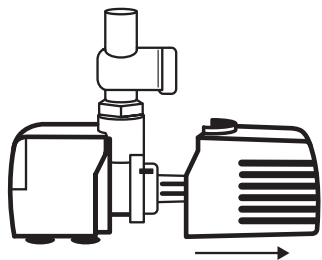

STEP 2: MINIPOND 700 (ROUTINE)

Remove pre-filter foam, and wash thoroughly in fresh water. A blocked foam will reduce the pump flow rate.

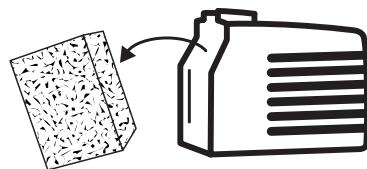

MAINTENANCE & CLEANING

STEP 1: MINIPOND 900Mk2 (ROUTINE)

Firmly pull pre-filter cage from pump motor.

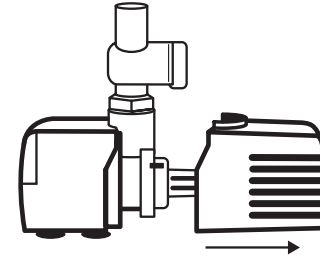

STEP 2: MINIPOND 900Mk2 (ROUTINE)

Remove pre-filter foam, and wash thoroughly in fresh water.

A blocked foam will reduce the pump flow rate.

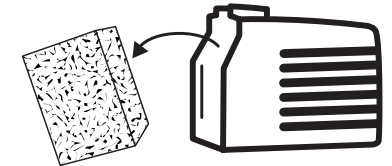

Monthly Maintenance

Following as for Routine Maintenance (steps 1 and 2) and then steps 3 and 4 (3 and 4 - 900 Mk2 model).

STEP 3: MINIPOND 700 (MONTHLY)

Remove impeller cover by turning anti-clockwise to release lock. Then pull firmly away from pump motor.

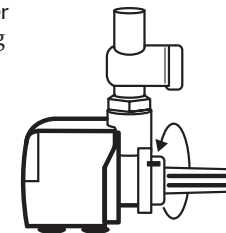

STEP 4: MINIPOND 700 (MONTHLY)

Remove impeller from pump motor. Wash parts with fresh water carefully.

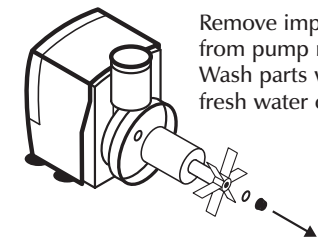

MAINTENANCE & CLEANING

STEP 3: MINIPOND 900 Mk2 (MONTHLY)

Remove impeller cover by turning anti-clockwise to release lock. Then pull firmly away from pump motor.

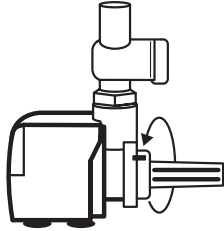

STEP 4: MINIPOND 900 Mk2 (MONTHLY)

Remove impeller from pump motor. Wash parts with fresh water carefully.

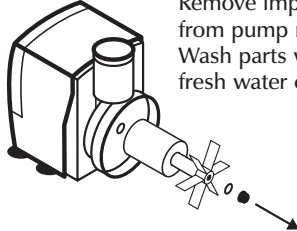

Annual Maintenance

Once a year you should service your pump by using Blagdon Pond Pump Cleaner, (this may need to be done more frequently in hard water areas).

Dismantle pump and examine all parts for wear or damage, replacing any parts that show obvious wear and/or damage. (See getting to know your pump for parts/description and replacement parts codes.) Particular care should be taken to examine the cable entry point and the cable; if there is any sign of damage the pump should be discarded.

Winter Storage

The pump can be run in the pond during the winter but care should be taken to ensure that it is fully immersed and cannot freeze solid. If the pump is not used during the winter, follow annual maintenance procedure and store frost-free in the house or garage until spring.

TROUBLESHOOTING

Problem

Low flow from pump

1. Follow routine cleaning procedure if no improvement.
2. Follow monthly cleaning procedure.
3. Ensure pipe work is not blocked, leaking or is laid so that it gets crushed or kinked.
4. Keep the height that water is to be pumped from the water surface (called Head) to a minimum. The higher the head the lower the flow rate and the more wear on the pump.
5. Use the largest diameter, smoothest bore pond hose over the shortest distance and keep hose fittings to a minimum. This removes frictional loss of flow and so increases pump flow rates.

Poor Fountain performance

- Reduced height.
- Jets blocked.

Clean flow adjuster and fountain head. Wash under a tap or hose. Blagdon Pond Pump Cleaner should be used to remove lime scale build-up/waste (see diagram) for improved results.

DAISY

To clean, remove head and rinse. Or in hard water areas, use Blagdon Pond Pump Cleaner.



No flow from pump

1. Check power supply is on.
2. Check fuse and wiring (SEE ELECTRICAL INSTALLATION).
3. Follow low flow procedure as above.

If none of the above works contact Interpet (Blagdon) Consumer Advice Department (See Faults problem procedure Page 12).

IMPORTANT

FAULTS - PROBLEMS PROCEDURE

Before returning your Minipond pump to your dealer or contacting our Consumer Advice Department, please carry out the following steps. This will solve most problems quickly and easily.

1. Ensure electrical procedure has been followed fully. Check fuse and any cable connectors/switch boxes.

NOTE: If the pump has overheated the thermal overload will temporarily switch off the pump.

2. **(a)** Follow routine maintenance and check pump. **(b)** Follow monthly maintenance and check pump. **(c)** Follow troubleshooting guide. **(d)** Follow annual maintenance guide.
3. Return pump to point of purchase for inspection and advice (You may need proof of purchase).

Consumer Advice contact details

Interpet (Blagdon) Consumer Advice Department

Vincent Lane, Dorking, Surrey RH4 3YX

Telephone: 01306 743747

(Monday to Friday 10am to 4pm except Bank Holidays - Times may vary)

Fax: 01306 876712

E-mail: customercare@interpet.co.uk

GUARANTEE

This product is guaranteed against defects in material and workmanship for 2 years from the date of purchase, under normal usage. **The guarantee DOES NOT APPLY in case of improper use**, negligence, lack of maintenance or accidental damage either to the pump or to the impeller or impeller shaft. If the pump fails due to a manufacturing fault within this period it will be either repaired or replaced free of charge. Liability is limited to replacement of the faulty product only, no other costs will be reimbursed.

This guarantee is not transferable and does not affect your statutory rights. This guarantee does not confer any rights other than those expressly set out above. Excludes the sponge pre-filter, which should be replaced every six months and the impeller, which may require replacing annually. If any parts need replacing, spares are available from your retailer.